



McGraw-Hill Connect
First Day of Class@Thammasat University

FN312 Investment- 2018 Semester 2



What are we covering today?

1. How to register an account?
2. How to get the best of Connect
 - 3.1 Tips on working on assignments
 - 3.2 SmartBook Assignment – Read/Practice
 - 3.3 How to access SmartBook & eBook
 - 3.2 Mobile option
3. Where can I go for help when needed?



What is McGraw-Hill Connect?

connect McGraw-Hill's Connect is a web-based assignment and assessment solution required for this course. The required electronic textbook is delivered in Connect. Connect assignments will make up a portion of your overall grade.



6115351979 Kantana Phataraphotiwong | [My account](#) | [Help](#) | [Sign out](#)

connect

Please update your Flash plug-in. [close this message](#) ✕

Troubleshoot before starting your work. We can [check your computer](#) and provide simple fixes.

Done making changes? [refresh this page](#)

my courses

Finance

▼ Thammasat University - Investments

Investments (SmartBook) (Bodie, 11e)

- LearnSmart
- Instructor Dr.Pym Manopimoke

Also includes:
Bodie, Investments, 11e (eBook) ()

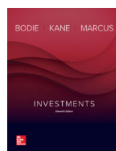

section

[NEW LOOK](#) **FN312 Investment - Semester 2 2018**



Go to <https://connect.mheducation.com> to login.

Bookmark this URL in your browser

User: school email : xxxxxx.a@st.econ.tu.ac.th

Password: Wsssss (firstname)+last4 digits of student ID

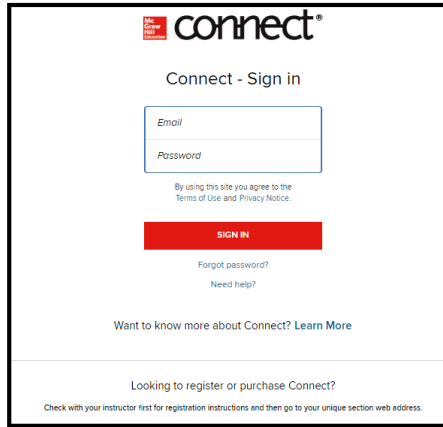

Student Home Page

Course Info

SmartBook

eBook

Assignment List

Sample

Getting Started in Connect

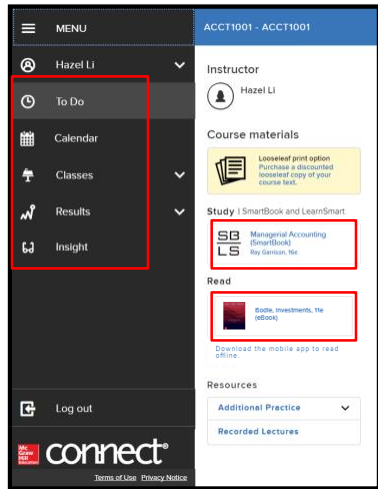

To Do

- Check any assignments assigned by your instructor

Classes

- Will show you what class you take

Results

- Check scores *for all attempts on all submitted assignments*

SmartBook

- Adaptive reading experience
- Learn via Reading & Practice
- With media learning resources (slides, video, library)

eBook

- bookmark, make notes and highlight

7



Tips on working on assignments

Take note of the start date and due date of assignment.

If you are not able to open assignment, check the start date.

Make sure you have not exceed the number of attempt(s)

Tips on working on assignments

[Save & Exit] To save your work to complete assignment later.

Ch 02 Quiz Saved Help Save & Exit Submit

9 Within her company, Maria utilizes a management style that varies according to the individual and environmental situation, with a strategy for minimizing errors by managing each stage of production. She has also set up a system with inputs, outputs, transformation processes, and feedback. Maria's management perspective is best described as

Multiple Choice

classical.

contemporary.

quantitative.

[Submit] When you are ready to have your assignment scored. Must click submit to end assignment.

Adaptive Reading Assignment

Week	Item	Start	Due	Item Type
Week 2	Adaptive Reading: The Exceptional Manager	1/22/2018	1/29/2018	SB LS
Week 3	Adaptive Reading: Managing the Organization's Environment	1/22/2018	1/29/2018	SB LS
Week 3	Activity: The Organization's Environment	1/22/2018	1/29/2018	Practice
Week 3	Adaptive Reading: The Manager's Changing Work Environment & Ethical Responsibilities	1/22/2018	1/29/2018	SB LS
Week 4				
Week 5				
Week 6				

In adaptive reading assignment, you are required to complete reading of assigned content and all practices before due date.

SmartBook Assignments

Welcome to

SMARTBOOK

McGraw-Hill Education

SmartBook is the first-ever adaptive reading experience.

Adaptive reading means that SmartBook will measure what you know. As you read and answer questions you will be guided to the part of the book that you need to learn at that moment.

SmartBook will help you study more effectively and get better grades.

Show Me!

The first time you launch a SmartBook assignment, you will be presented with a brief tutorial that explains how SmartBook works.

11

SmartBook Assignment- Read/Practice

General Chemistry - Chemistry: The Molecular Nature of Matter and Change - Silberberg/Amatels, 8e, Keys to Study

8 / 1119

The Importance of Energy in the Study of Matter

Physical and chemical processes are often accompanied by energy changes. **Energy** is often defined as the ability to do work. Essentially, all work involves energy. When your arm lifts a book, when a car's engine moves the wheels, or when a falling rock moves the ground as it lands, the engine, rock) transfers some of the energy it possesses to the object on which the work is done (book, wheels, ground).

The total energy an object possesses is the sum of its potential energy and its kinetic energy.

- **Potential energy** is the energy due to the position of the object relative to other objects.
- **Kinetic energy** is the energy due to the motion of the object.

Let's examine four systems that illustrate the relationship between these two forms of energy: a weight raised above the ground, two balls attached by a spring, two electrically charged particles, and a fuel and its waste products. Two concepts central to all these cases are

1. When energy is converted from one form to the other, it is conserved, not destroyed.
2. Situations of lower energy are more stable and are favored over situations of higher energy, which are less stable.

The four cases are

- A weight raised above the ground (Figure 1.3A). The energy you exert to lift a weight against gravity increases the weight's potential energy (energy

Practice

Previous Highlight Previous Section Next Section Next Highlight

Yellow Highlights shows students where to focus their readings.

After reading a while, the Practice icon will glow, indicating it is time for you to practice. Answer questions about what you just read to help reinforce what you have learned.

Always click on Next Highlight to read the next important key points

SmartBook Assignment- Read/Practice

Which of the following are physical properties? Select all that apply.

Check all that apply.

flammability

hardness

density

boiling point

corrosiveness

Do you know the answer?

Answer the question to the best of your ability and select a confidence level honestly. This allows SmartBook to adapt to your ability. You are not penalized for wrong answers.

Which of the following are physical properties? Select all that apply.

✓ Your answer is almost correct.

flammability

hardness

density

boiling point
The chemical composition of a substance does not change when it boils. The boiling point is therefore a physical property.

corrosiveness

Practice auto-mark and provide you explanations.

You can also choose "Read about this" before or after answering a question.

SmartBook Assignment- Read/Practice

The Properties of Matter and Changes

We learn about matter by its **properties**, the characteristics that give each substance its unique identity. To identify a person, we might observe height, weight, and eye color, fingerprints, and, now, even DNA patterns, until we arrive at a unique identification. To identify a substance, we observe two types of properties, physical and chemical, which are closely related to two types of change that matter undergoes.

Physical Change: No Change in Composition

Physical properties are characteristics a substance shows by itself, without changing into or interacting with another substance. These properties include color, melting point, electrical conductivity, and density. A **physical change** occurs when a substance alters its physical properties, **not its composition**. For example, when ice melts, several physical properties change, such as hardness, density, and ability to flow. But the composition of the sample does not change: it is still water. The photograph in **Figure 1.2A** shows what this change looks like in everyday life. The "blow-up" circles present a magnified view of the particles making up the sample. In the ice cube, the particles lie in the repeating pattern characteristic of a solid, whereas they are disordered in the liquid droplet; however, the particles are the same in both states of water.

Physical change (substance before and after):

Water (solid state) → water (liquid state)

All changes of state of water are physical changes.

"Read about this" brings you to the yellow highlights that contain text related to the questions. You can toggle between question and text to help you answer.

SmartBook Assignment- Read/Practice

Since demand curves and other material in this chapter make extensive use of lines and linear equations, you may want to review those concepts in Appendix B, "Math Essentials: Working with Linear Equations," which follows this chapter.

On the demand curve, quantity goes on the horizontal axis and price on the vertical axis. The result is a downward-sloping line that reflects the inverse relationship between price and quantity demanded. Figure 3-1 represents exactly the same information.

Determinants of demand

The demand curve represents the relationship between price and quantity demanded with *nothing else held constant*. If everything else is *not* held constant—that is, if one of the nonprice factors that determines demand changes—the curve will shift.

The downward-sloping demand curve reflects the trade-offs that people face between (1) the benefit they expect to receive from a good and (2) the opportunity cost they face for buying it. Therefore, any factor that changes this balance at a given price will change people's willingness to buy, and thus their purchasing decisions.

The nonprice determinants of demand can be divided into five major categories:

- Consumer preferences.
- The prices of related goods.
- Income of the consumers.
- Expectations of future prices.
- The number of buyers in the market.

Table 3-2 summarizes the impact of each factor on demand. Each of these nonprice determinants affects either the benefits or the opportunity cost of buying a good, even if the price of the good itself remains the same.

The Yellow Highlights will turn to Green when you mastered the content.

Your goal is for all of the highlights in the chapter to be green, showing you that you have mastered the content.

The Practice will always load questions on area of content you have not mastered remembering or understanding

SmartBook Assignment- Completion

There are 10^3 microseconds in 1 second.

There are 1000 g in one kg.

Do you know the answer?

47 Items left

Monitor your progress on number of item left. Ensure you have no item left to complete assignment.

SmartBook Assignment- Completion

Congratulations!

You have just completed :
Chapter 1, The Beginning of a Nation

You are currently
Online

Your work has been saved

Your progress will be automatically saved as you work and you will see this screen after you complete your assignment.

SmartBook Assignment - Reports

Click to expand menu

Use the Reports section to evaluate your performance and help you use SmartBook more efficiently.

The screenshot shows the SmartBook interface with the following elements:

- Left Sidebar (Menu):**
 - mstudent1@u
 - Type here...
 - Table of Contents
 - Notes and Underlines
 - Reports** (highlighted)
 - Current Learning Status
 - Topic Scores
 - Missed Questions
 - Most Challenging LOs
 - Self-Assessment
 - Tree of Knowledge
 - Practice Quiz
 - Settings
 - Help
 - Leave SmartBook
- Main Content Area (Reports):**
 - Current Learning Status**: View how much you have left to learn and how much you should refresh so that you don't forget your new knowledge.
 - Topic Scores**: View the modules and sections you struggled with the most. You can look up each challenging section for more study.
 - Missed Questions**: View frequently missed questions. You can practice questions you recently got wrong.
 - Most Challenging Learning Objectives**: View the learning objectives that are the hardest for you. You can look these up in your book in order to study them further.
 - Self-Assessment**: View how aware you were of whether or not you know the answers. This awareness can help you study more effectively.
 - Tree of Knowledge**: Watch your tree grow as you learn.

SmartBook Assignment - Recharge

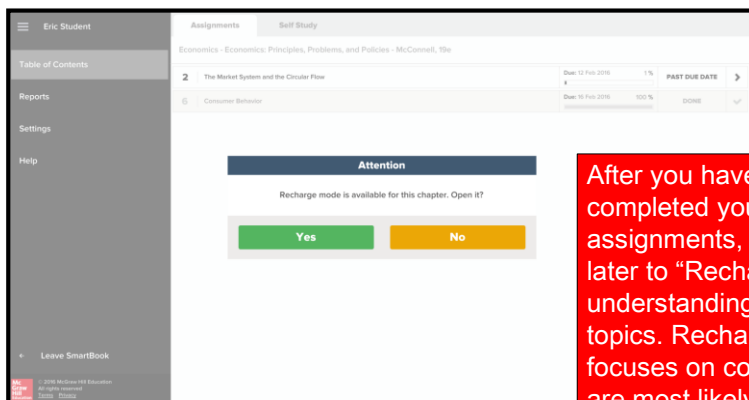

After you have completed your assignments, come back later to "Recharge" your understanding of the topics. Recharge focuses on content you are most likely to forget first to make for efficient use of your time.

How to access eBook?

Click on **(A)** to launch eBook

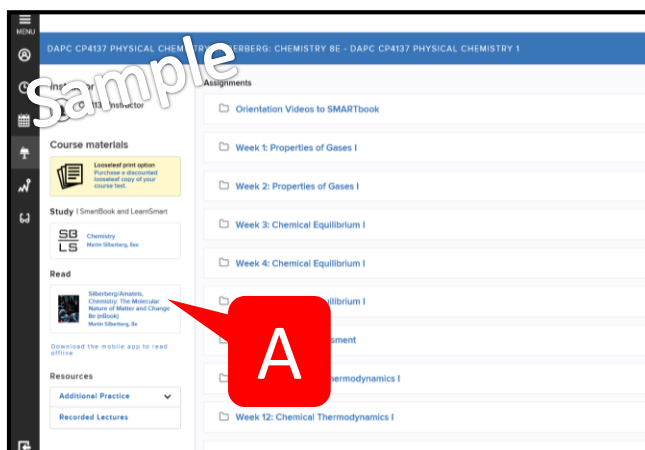

How to access eBook?

Search tool

Expand to see TOC

1.1 Some Fundamental Definitions

A good place to begin our exploration of chemistry is by defining a few central concepts. **Chemistry** is the scientific study of matter and its properties—the changes that matter undergoes, and the energy associated with those changes. **Matter** is the “stuff” of the universe: air, water, and anything that has mass and volume. (In Section 1.2, we discuss the meanings of mass and volume in terms of how they are measured.) Chemists want to know the **composition** and amounts of simpler substances that make it up. A **substance** is a type of matter that has a defined, fixed

The States of Matter

Matter occurs commonly in *three physical forms* called **states**: solid, liquid, and gas. On the macroscopic level, matter is defined by the way the sample fills a container (Figure 1.1, *flasks at top*):

- A **solid** has a fixed shape that does not conform to the container shape. Solids are *not* defined by rigid boundaries; iron is rigid and hard, but solid lead is flexible, and solid wax is soft.
- A **liquid** has a varying shape that conforms to the container shape, but only to the extent of the liquid's volume.

Right click to highlight keywords

You can:

- Add your own notes
- Add placemark
- Select the sentences to be read out

21

How to access eBook?

Search tool

Right click to highlight keywords

You can:

- Add your own notes
- Add placemark
- Select the sentences to be read out

22

Account Setting and Result

Click (A) to expand menu. Go to (B) to change profile/first name/last name. Go to (C) to view your results



23

Mobile Option 1 – ReadAnywhere App



Access your eBook on the go with the **ReadAnywhere App***



*You have to log into the app using the email and password you entered during registration.

ReadAnywhere App Experience

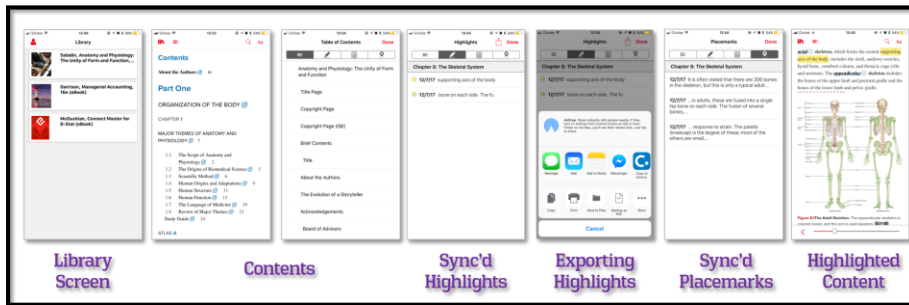

Go here to download apps:

https://www.mheducation.com/highered/explore/readanywhere.html?external_browser=2

Mobile Option 2 – SmartBook App



Access your eBook on the go with the **SmartBook App***.



*You have to log into the app using the email and password you entered during registration.

Where to get help?

Digital Technical Support:

- 1) Call : 001-800-881-39190
- 2) Email & Chat : <https://mhedu.force.com/CXG/s/ContactUs>

Training & Tutorials:
<http://connectstudentsuccess.com>

Where to get help?

Contact Support

Visit: <https://mhedu.force.com/CXG/s/ContactUs>

• Email • Live Chat • Phone

CONTACT CXG SUPPORT - WORLDWIDE

EMAIL
All products & Topics

LIVE CHAT
CHAT TOPICS:

- Connect Registration Support
- Connect Product Support
- All Other Products Support

PHONE
USA & Canada: (800) 331 5094
Other Global Regions:
Asia
 China, Hong Kong, Malaysia, Philippines, Singapore, South Korea, Taiwan, Thailand
 Phone: +800-881-39190

ANNOUNCEMENTS
 • 06/26/17 – Welcome to our new and improved support page! The design will help you get the answers you need quickly from your desktop, phone or tablet. Use the Home page to search by customer type, product type, function, or any combination of the three. Still need help? Use the Contact Support link to phone, email, or chat and be sure to tell us what you think!

CXG SUPPORT HOURS (USA Eastern Time)

Sunday	12 PM - 12 AM
Monday - Thursday	24 hours
Friday	12 AM - 9 PM
Saturday	10 AM - 8 PM

McGraw-Hill Education Australia Pty. Ltd.
Level 33, 680 George Street
Sydney, NSW, 2000

How to Optimize Your Computer for Connect?

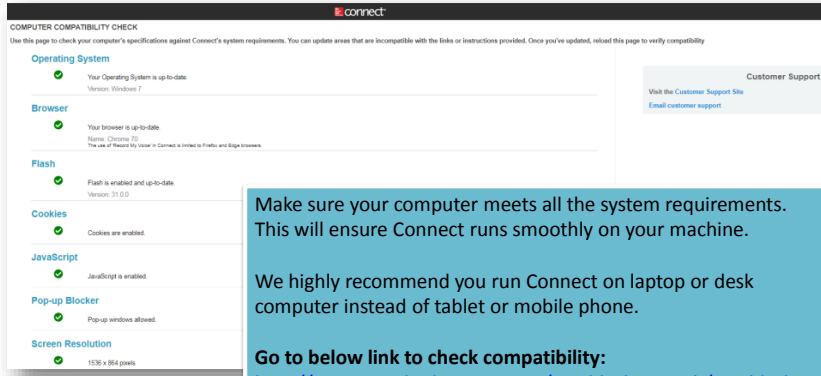

Make sure your computer meets all the system requirements. This will ensure Connect runs smoothly on your machine.

We highly recommend you run Connect on laptop or desk computer instead of tablet or mobile phone.

Go to below link to check compatibility:

<http://connect.mheducation.com/troubleshootWeb/troubleshoot.html>

29

Go to <https://connect.mheducation.com> to login the next time. Bookmark this URL in your browser

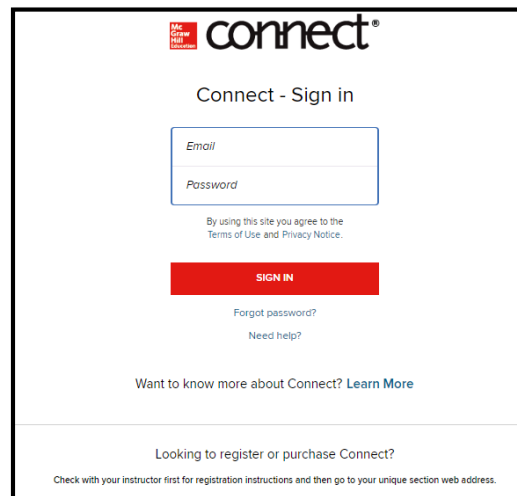

30

